



TORINCAB2 s.r.l.

SEDE LEGALE ED AMMINISTRATIVA:
Via DRUBIAGLIO 6/17
10040 Frazione RIVERA – ALMESE (TO)
TEL. +39 (0) 119352688
FAX. +39 (0) 119352838
Web: www.torincab2.com

Cap. Soc. € 10.000,00
Isc. al Reg. delle Imp. di Torino N. 05655530011
Albo Imprese Artigiane N. 307836
Partita IVA e Cod. Fisc. 05655530011
E-mail: info@torincab2.com

CABIN FOR TRACTORS:

New Holland T4.80V - T4.90V - T4.100V - T4.110V - T4.120V *Stage V*

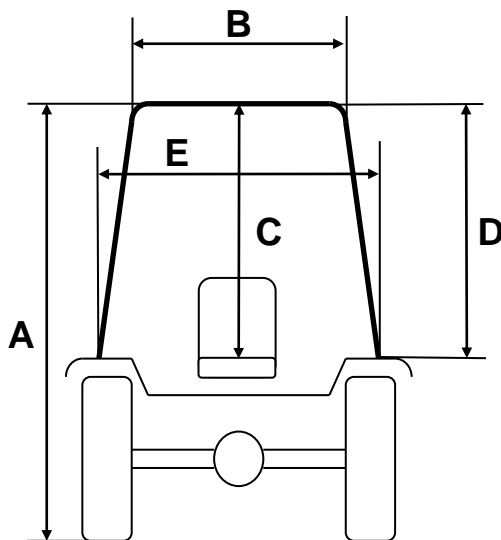

Cabina New Holland T4.90V <i>Stage V</i>	
BACK TYRES 360/70 R.28	
<i>Rear fenders in TALL position</i>	
A	2320 mm
B	1000 mm
C	990 mm
D	1000 mm
E	1020 mm

