



TORINCAB2 s.r.l.

SEDE LEGALE ED AMMINISTRATIVA:
Via DRUBIAGLIO 6/17
10040 Frazione RIVERA – ALMESE (TO)
TEL. +39 (0) 119352688
FAX. +39 (0) 119352838
Web: www.torincab2.com

Cap. Soc. € 10.000,00
Isc. al Reg. delle Imp. di Torino N. 05655530011
Albo Imprese Artigiane N. 307836
Partita IVA e Cod. Fisc. 05655530011
E-mail: info@torincab2.com

CABIN FOR TRACTORS:

New Holland T4.80 - T4.90 - T4.100 - T4.110 - T4.120 + **BASSOTTO Stage V**

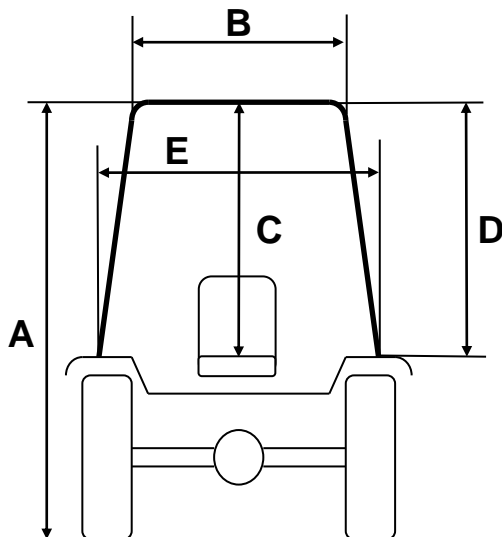

Cabin New Holland T4.80+BASSOTTO Stage V
BACK TYRES 360/70 R.20

Rear fenders in LOW position

A	2205 mm
B	1010 mm
C	1005 mm
D	1085 mm
E	1210 mm

