



# TORINCAB2 s.r.l.

SEDE LEGALE ED AMMINISTRATIVA:  
Via DRUBIAGLIO 6/17  
10040 Frazione RIVERA – ALMESE (TO)  
TEL. +39 (0) 119352688  
FAX. +39 (0) 119352838  
Web: [www.torincab2.com](http://www.torincab2.com)

Cap. Soc. € 10.000,00  
Isc. al Reg. delle Imp. di Torino N. 05655530011  
Albo Imprese Artigiane N. 307836  
Partita IVA e Cod. Fisc. 05655530011  
E-mail: [info@torincab2.com](mailto:info@torincab2.com)

**“COMPACT” LOW-ROFILE CABIN FOR TRACTORS:**

**DEUTZ-FAHR 5080DS-5090DS-5100DS-5090.4DS-5105DS-5115DS**

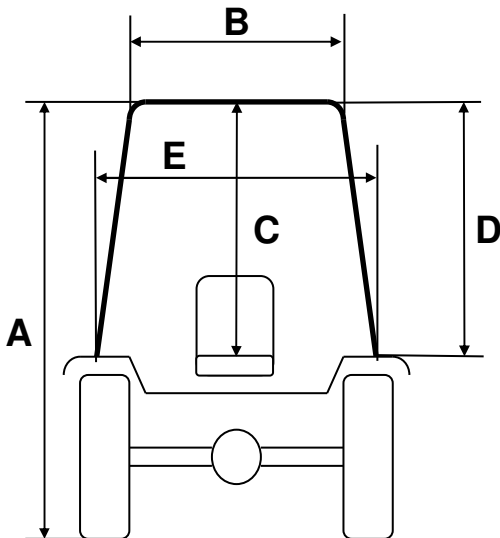

<b>“COMPACT” CABIN DEUTZ-FAHR 5115 DS</b>	
BACK TYRES 380/70 R.24	
<i>TRACTOR WITH LOW PLATFORM</i>	
<b>A</b>	1970 mm
<b>B</b>	760 mm
<b>C</b>	940 mm
<b>D</b>	780 mm
<b>E</b>	870 mm

