



TORINCAB2 s.r.l.

SEDE LEGALE ED AMMINISTRATIVA:
Via DRUBIAGLIO 6/17
10040 Frazione RIVERA – ALMESE (TO)
TEL. +39 (0) 119352688
FAX. +39 (0) 119352838
Web: www.torincab2.com

Cap. Soc. € 10.000,00
Isc. al Reg. delle Imp. di Torino N. 05655530011
Albo Imprese Artigiane N. 307836
Partita IVA e Cod. Fisc. 05655530011
E-mail: info@torincab2.com

NEW "COMPACT" LOW-PROFILE CABIN FOR SERIES:

VALPADANA

9095 – 90105 IS

REVERSIBLE

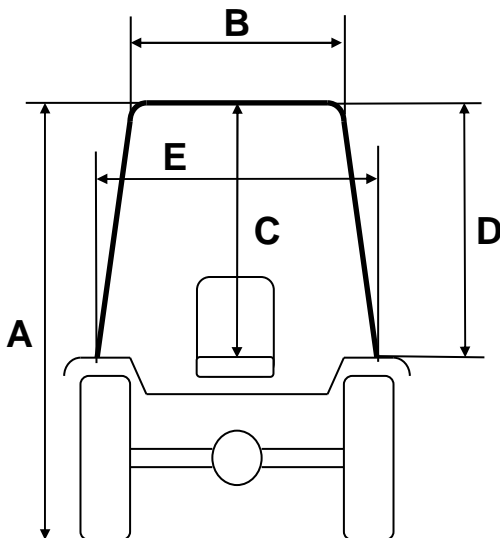

"COMPACT" CABIN VALPADANA 90105 IS REV.	
Tractor Tyres 360/70 R.20	
A	1900 mm
B	730 mm
C	930 mm
D	900 mm
E	915 mm

