



TORINCAB2 s.r.l.

SEDE LEGALE ED AMMINISTRATIVA:
Via DRUBIAGLIO 6/17
10040 Frazione RIVERA – ALMESE (TO)
TEL. +39 (0) 119352688
FAX. +39 (0) 119352838
Web: www.torincab2.com

Cap. Soc. € 10.000,00
Isc. al Reg. delle Imp. di Torino N. 05655530011
Albo Imprese Artigiane N. 307836
Partita IVA e Cod. Fisc. 05655530011
E-mail: info@torincab2.com

CABIN LANDINI REX 4 GT

REX 4-080 GT | REX 4-090 GT | REX 4-100 GT | REX 4-110 GT | REX 4-120 GT

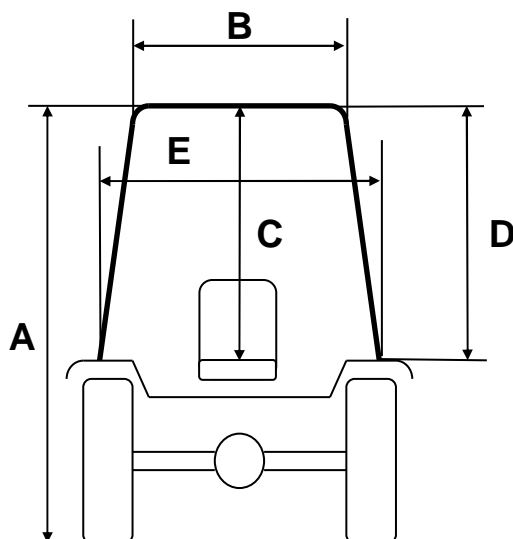

CABIN Landini REX 4 GT	
Back Tyres 420/70 R.24	
<i>Rear mudguards LOW</i>	
A	2290 mm
B	1010 mm
C	1000 mm
D	950 mm
E	1090 mm

CABINA Landini REX 4 "GT"	
Back Tyres 420/70 R.28	
<i>Rear mudguards TALL</i>	
A	2350 mm
B	1010 mm
C	1000 mm
D	920 mm
E	1090 mm

