



TORINCAB2 s.r.l.

SEDE LEGALE ED AMMINISTRATIVA:
Via DRUBIAGLIO 6/17
10040 Frazione RIVERA – ALMESE (TO)
TEL. +39 (0) 119352688
FAX. +39 (0) 119352838
Web: www.torincab2.com

Cap. Soc. € 10.000,00
Isc. al Reg. delle Imp. di Torino N. 05655530011
Albo Imprese Artigiane N. 307836
Partita IVA e Cod. Fisc. 05655530011
E-mail: info@torincab2.com

NEW CABIN FOR TRACTORS:

DEUTZ-FAHR

AGROPLUS "F"

320-410-420-430 Euro III

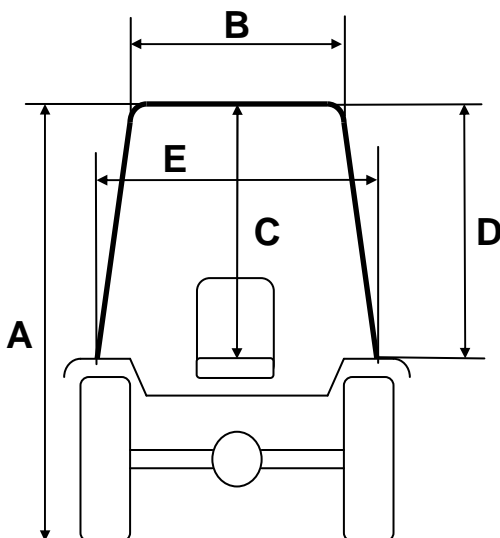

CABIN DEUTZ-FAHR AGROPLUS "F" EuroIII

Back Tyres 420/70 R.28

Rear mudguards TALL

A	2280 mm
B	900 mm
C	1120 mm
D	870 mm
E	1050 mm

CABIN DEUTZ-FAHR AGROPLUS "F" EuroIII

Back Tyres 360/70 R.24

Rear mudguards LOW

A	2160 mm
B	900 mm
C	1060 mm
D	930 mm
E	1050 mm

