



TORINCAB2 s.r.l.

SEDE LEGALE ED AMMINISTRATIVA:
Via DRUBIAGLIO 6/17
10040 Frazione RIVERA – ALMESE (TO)
TEL. +39 (0) 119352688
FAX. +39 (0) 119352838
Web: www.torincab2.com

Cap. Soc. € 10.000,00
Isc. al Reg. delle Imp. di Torino N. 05655530011
Albo Imprese Artigiane N. 307836
Partita IVA e Cod. Fisc. 05655530011
E-mail: info@torincab2.com

NEW CABIN FOR TRACTORS:

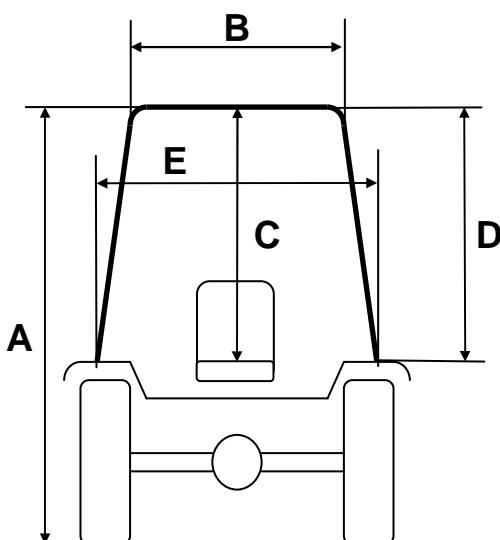

CABIN Deutz-Fahr AGROLUX 310-320-410 <i>EuroIII</i>	
Back Tyres 340/85 R.28	
Rear mudguards LOW	
A	2360 mm
B	1100 mm
C	1050 mm
D	990 mm
E	1180 mm
CABIN Deutz-Fahr AGROLUX 310-320-410 <i>EuroIII</i>	
Back Tyres 16.9 R.30	
Rear mudguards TALL	
A	2440 mm
B	1100 mm
C	1050 mm
D	930 mm
E	1180 mm

