



# TORINCAB2 s.r.l.

SEDE LEGALE ED AMMINISTRATIVA:  
Via DRUBIAGLIO 6/17  
10040 Frazione RIVERA – ALMESE (TO)  
TEL. (0039) 0119352688  
FAX. (0039) 0119352838

Cap. Soc. € 10.000,00  
Isc. al Reg. delle Imp. di Torino N. 05655530011  
Albo Imprese Artigiane N.307836  
Partita IVA e Cod. Fisc. 05655530011  
E-mail: [info@torincab2.com](mailto:info@torincab2.com)  
Sito: [www.torincab2.com](http://www.torincab2.com)

## NEW CABIN FOR TRACTORS:

**FERRARI**

**VEGA V80 - 75 – 85 – 95**

**RS Reversible**

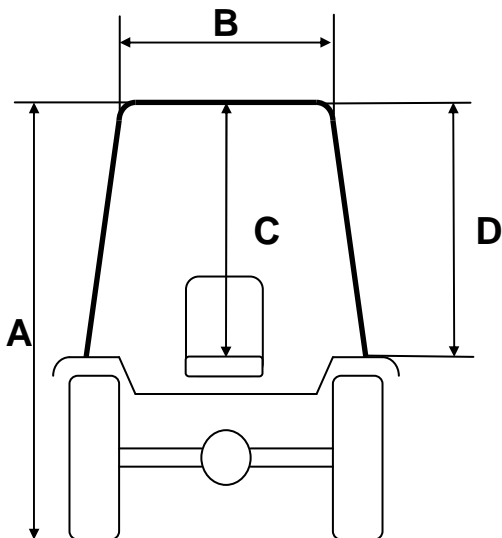

**Cabin FERRARI VEGA RS Rev.**  
Tractor Tyres 320/65 R.18

<b>A</b>	2110 mm
<b>B</b>	800 mm
<b>C</b>	990 mm
<b>D</b>	1110 mm

