



TORINCAB2 s.r.l.

SEDE LEGALE ED AMMINISTRATIVA:
Via DRUBIAGLIO 6/17
10040 Frazione RIVERA – ALMESE (TO)
TEL. +39 (0) 119352688
FAX. +39 (0) 119352838
Web: www.torincab2.com

Cap. Soc. € 10.000,00
Isc. al Reg. delle Imp. di Torino N. 05655530011
Albo Imprese Artigiane N. 307836
Partita IVA e Cod. Fisc. 05655530011
E-mail: info@torincab2.com

NEW CABIN FOR TRACTORS:

DEUTZ-FAHR AGROPLUS "F" Ecoline 310-315-320-405-410-420 Euro III

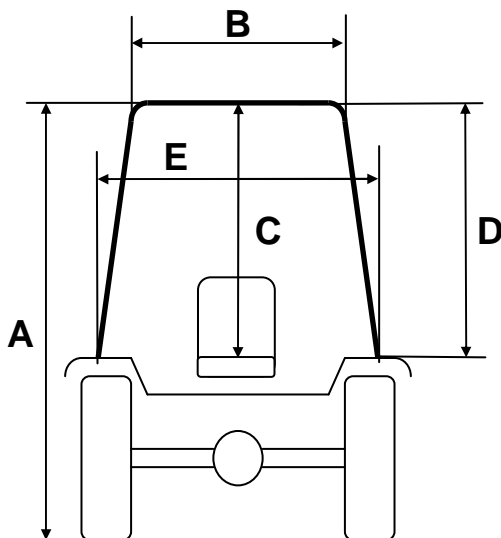

CABIN DEUTZ-FAHR AGROPLUS "F" Ecoline EuroIII Back Tyres 420/70 R.28 <i>Rear mudguards TALL</i>	
A	2230 mm
B	900 mm
C	1120 mm
D	910 mm
E	1040 mm
CABIN DEUTZ-FAHR AGROPLUS "F" Ecoline EuroIII Back Tyres 360/70 R.24 <i>Rear mudguards LOW</i>	
A	2200 mm
B	900 mm
C	1060 mm
D	960 mm
E	1050 mm

