



TORINCAB2 s.r.l.

SEDE LEGALE ED AMMINISTRATIVA:
Via DRUBIAGLIO 6/17
10040 Frazione RIVERA – ALMESE (TO)
TEL. (0039) 0119352688
FAX. (0039) 0119352838
Sito: www.torincab2.com

Cap. Soc. € 10.000,00
Isc. al Reg. delle Imp. di Torino N. 05655530011
Albo Imprese Artigiane N.307836
Partita IVA e Cod. Fisc. 05655530011
E-mail: info@torincab2.com

NEW CABIN FOR TRACTOR

BCS

VOLCAN V800 = 750 – 850 – 950

DUALSTEER



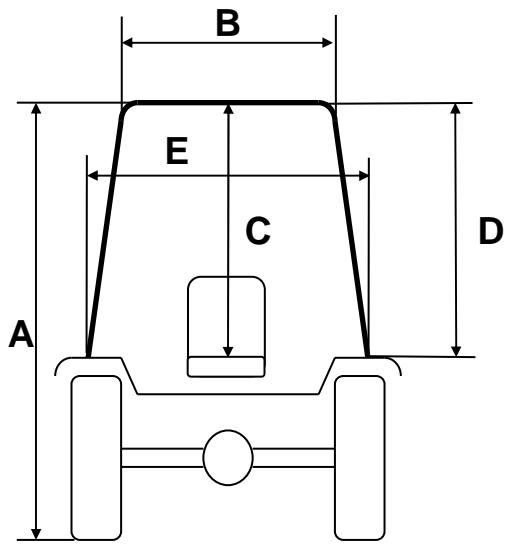

Cabin BCS Volcan DUALSTEER Tractor Tyres 300/70 R.20	
A	2150 mm
B	800 mm
C	1000 mm
D	1120 mm
E	1060 mm

