



TORINCAB2 s.r.l.

SEDE LEGALE ED AMMINISTRATIVA:
Via DRUBIAGLIO 6/17
10040 Frazione RIVERA – ALMESE (TO)
TEL. +39 (0) 119352688
FAX. +39 (0) 119352838
Web: www.torincab2.com

Cap. Soc. € 10.000,00
Isc. al Reg. delle Imp. di Torino N. 05655530011
Albo Imprese Artigiane N. 307836
Partita IVA e Cod. Fisc. 05655530011
E-mail: info@torincab2.com

NEW CABIN FOR TRACTORS:

SAME	EXPLORER3 "T"	85 – 100 EuroIII
	EXPLORER3 "T"	90 – 105 CLASSIC EuroIII

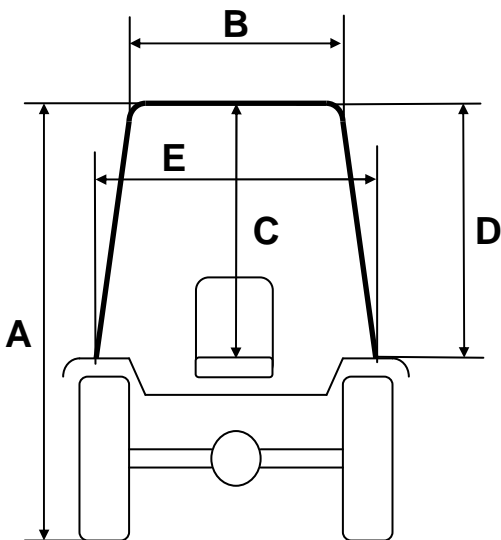

CABIN SAME EXPLORER3 "T" 85-100 EuroIII

Back Tyres 420/85 R.30

Rear mudguards LOW

A	2500 mm
B	1100 mm
C	1050 mm
D	930 mm
E	1250 mm

CABINA SAME EXPLORER3 "T" 85-100 EuroIII

Back Tyres 420/85 R.34

Rear mudguards TALL

A	2570 mm
B	1100 mm
C	1050 mm
D	890 mm
E	1250 mm

