



# TORINCAB2 s.r.l.

SEDE LEGALE ED AMMINISTRATIVA:  
Via DRUBIAGLIO 6/17  
10040 Frazione RIVERA – ALMESE (TO)  
TEL. +39 (0) 119352688  
FAX. +39 (0) 119352838  
Web: [www.torincab2.com](http://www.torincab2.com)

Cap. Soc. € 10.000,00  
Isc. al Reg. delle Imp. di Torino N. 05655530011  
Albo Imprese Artigiane N. 307836  
Partita IVA e Cod. Fisc. 05655530011  
E-mail: [info@torincab2.com](mailto:info@torincab2.com)

## NEW TORINCAB CABIN FOR CRAWLER:

**NEW HOLLAND TK4.90 – TK4.90M – TK4.100 – TK4.100M**



Cabin	A	B	C	D
Crawler NEW HOLLAND TK4.90	2230mm	910mm	980mm	1340mm

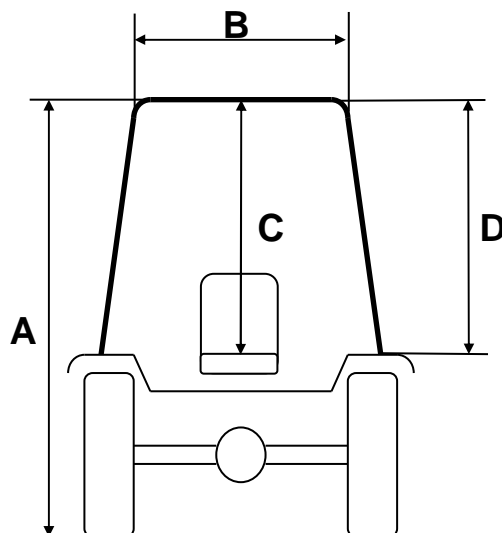



**TOTAL REAR  
VISIBILITY**



**TOTAL CLOSURE  
DRIVE-PLACE**

