



TORINCAB2 s.r.l.

SEDE LEGALE ED AMMINISTRATIVA:
Via DRUBIAGLIO 6/17
10040 Frazione RIVERA – ALMESE (TO)
TEL. +39 (0) 119352688
FAX. +39 (0) 119352838
Web: www.torincab2.com

Cap. Soc. € 10.000,00
Isc. al Reg. delle Imp. di Torino N. 05655530011
Albo Imprese Artigiane N. 307836
Partita IVA e Cod. Fisc. 05655530011
E-mail: info@torincab2.com

CABINA for series: NEW HOLLAND Series TD5000 - TDD Plus - TDD

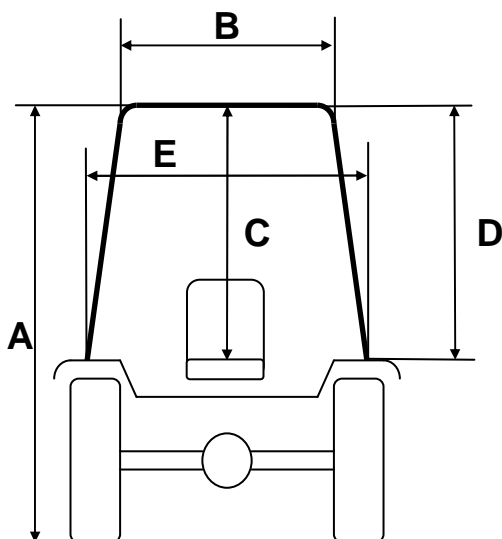

CABIN NEW HOLLAND TDD Back Tyres R.38	
A	2670 mm
B	1100 Ant. / 1200 Post. mm
C	1010 mm
D	960 mm
E	1310 mm

