



TORINCAB2 s.r.l.

SEDE LEGALE ED AMMINISTRATIVA:
Via DRUBIAGLIO 6/17
10040 Frazione RIVERA – ALMESE (TO)
TEL. +39 (0) 119352688
FAX. +39 (0) 119352838
Web: www.torincab2.com

Cap. Soc. € 10.000,00
Isc. al Reg. delle Imp. di Torino N. 05655530011
Albo Imprese Artigiane N. 307836
Partita IVA e Cod. Fisc. 05655530011
E-mail: info@torincab2.com

CABIN for series:
NEW HOLLAND Series T4000 Deluxe & SuperSteer - TND/A - TNS/A - TND - TNS

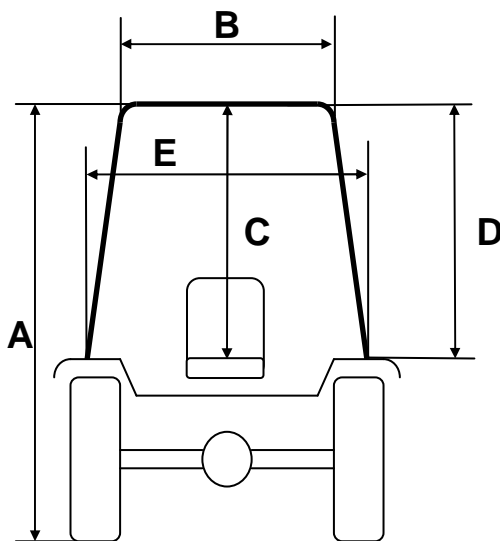

CABIN NEW HOLLAND T4030 DELUXE	
Back Tyres 420/85 R.30	
A	2450 mm
B	1100 mm
C	1100 mm
D	900 mm
E	1190 mm



FRONT PART CABIN